

BBV 500N BAR SYSTEM

Conforming to AS/NZS 4671 standard and certified by ACRS. Produced under quality management systems ISO 9001 : 2008.

Robust hot rolled continuous thread profile offers high bond strength, can be cut and coupled at any point, low susceptibility to mechanical damage, easy installation and cleaning.

Supported with a wide range of proprietary accessories to accommodate multiple applications. Tailor made solutions can also be designed on a case by case basis.

Corrosion protection systems for geotechnical application in accordance with BS8081, DIN EN 1537 : 2001 or other international standards can be provided. Hot dip galvanizing of bars and accessories upon request.

Value added services including cutting and bending or prefabrication of cages and modules upon request.

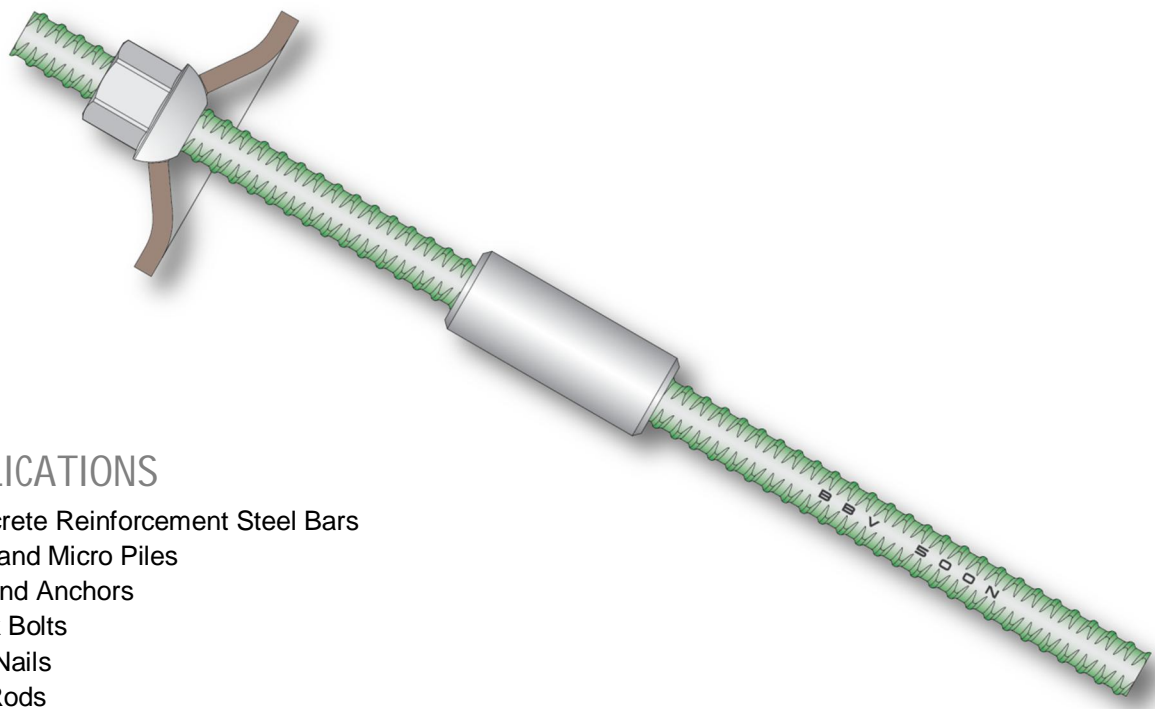

APPLICATIONS

- Concrete Reinforcement Steel Bars
- Mini and Micro Piles
- Ground Anchors
- Rock Bolts
- Soil Nails
- Tie Rods

BBV 500N BAR PROPERTIES

Steel Grade*	N/mm ²	500N					
		16	20	25	28	32	40
Nominal Bar Diameter	mm	16	20	25	28	32	40
Article No. 645 00 _ _ _ 3600	-	516	520	525	528	532	540
Nominal Sectional Area	mm ²	201	314	491	615	804	1260
Nominal Weight	kg/m	1.58	2.47	3.85	4.83	6.31	9.86
Over Thread Diameter	mm	17.6	22.0	27.6	31.0	35.3	43.8
Pitch, left-hand Thread	mm	9	9	11	13	14	16
Yield Strength (Re)*	N/mm ²	500 - 650	500 - 650	500 - 650	500 - 650	500 - 650	500 - 650
Tensile Strength (Rm)*	N/mm ²	-	-	-	-	-	-
Ratio (Rm/Re)*	-	1.08	1.08	1.08	1.08	1.08	1.08
Min. Uniform Elongation Agt*	%	5	5	5	5	5	5
Min. Yield Load*	kN	101	157	246	308	402	630
Min. Ultimate Load**	kN	125	195	304	381	498	781

* Conforming to AS/NZS 4671:2001

** Product specification

SPHERICAL ANCHORAGE ACCESSORIES

System Grade	500N					
Bar Diameter	16	20	25	28	32	40

NUTS

Spherical Nut 55° (cast)

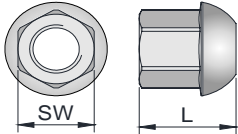

Article No. 475 00 ___ 3600	516	520	525	528	532	540
L mm	35	45	52	59	64	75
SW mm	27	33	41	46	53	65
Unit Weight kg	0.14	0.25	0.38	0.55	0.77	1.46

PLATES

Pressed Plate Type S*

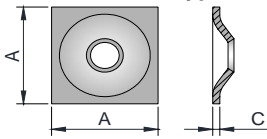

Article No. 753 ___ 3600	04 516	04 520	04 525	04 528	04 532	04 540
A mm	150	150	150	150	150	150
C mm	10	10	10	10	10	10
Unit Weight kg			1.74	1.71		

Pressed Plate Type S*

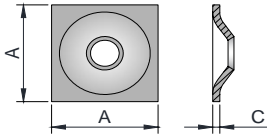

Article No. 753 ___ 3600	08 516	08 520	08 525	08 528	08 532	08 540
A mm	200	200	200	200	200	200
C mm	12	12	12	12	12	12
Unit Weight kg			3.72	3.68		

Pressed Plate Type S*

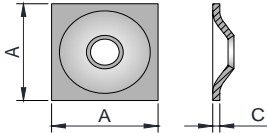

Article No. 753 ___ 3600	09 516	09 520	09 525	09 528	09 532	09 540
A mm	200	200	200	200	200	200
C mm	16	16	16	16	16	16
Unit Weight kg					4.80	

Pressed Plate Type S*

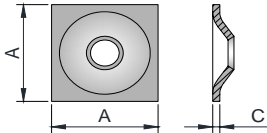

Article No. 753 ___ 3600	11 516	11 520	11 525	11 528	11 532	11 540
A mm	250	250	250	250	250	250
C mm	12	12	12	12	12	12
Unit Weight kg			5.84			

Pressed Plate Type S*

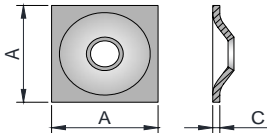

Article No. 753 ___ 3600	12 516	12 520	12 525	12 528	12 532	12 540
A mm	250	250	250	250	250	250
C mm	16	16	16	16	16	16
Unit Weight kg				7.68		

Anchor Plate for Nut 55°

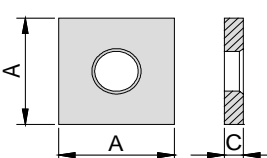

Article No. 022 ___ 3600	50 516	50 516	50 516	50 516	50 516	50 516
A mm	as per customer requirement					
C mm	as per customer requirement					
Unit Weight kg						

* Other sizes are also available upon special arrangement.

FLAT ANCHORAGE ACCESSORIES

System Grade	500N					
Bar Diameter	16	20	25	28	32	40

NUTS

Hex Nut (cast)

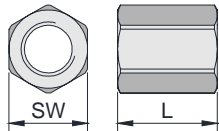

Article No. 476 00 ___ 3600	516	520	525	528	532	540
L mm	35	45	52	59	64	75
SW mm	27	33	41	46	53	65
Unit Weight kg	0.10	0.19	0.34	0.49	0.71	1.23

Hex Nut (machined)

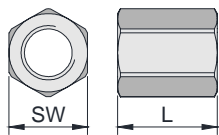

Article No. 476 05 ___ 3600	516	520	525	528	532	540
L mm	35	45	52	59	64	75
SW mm	27	33	41	46	53	65
Unit Weight kg	0.11	0.21	0.37	0.53	0.77	1.34

Round Nut (machined)

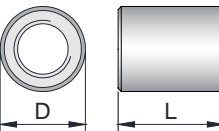

Article No. 482 00 ___ 3600	516	520	525	528	532	540
L mm	35	45	52	59	64	75
D mm	28	35	42	48	55	65
Unit Weight kg	0.10	0.21	0.34	0.52	0.71	1.14

Anchor Piece (Cast)

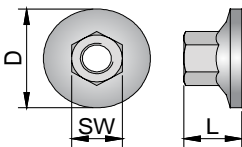

Article No. 028 00 ___ 3600	516	520	525	528	532	540
L mm	35	45	52	59	64	75
SW mm	27	33	41	46	53	65
D mm	as per customer requirement					
Unit Weight kg						

PLATES

Anchor Plate*

Article No. 021 ___ 3600	00 516	00 520	00 525	00 528	00 532	00 540
A mm	60	75	90	100	120	145
C mm	10	12	15	20	25	25
Unit Weight kg						

* Other sizes are also available upon special arrangement.

COUPLER ACCESSORIES

System Grade	500N					
Bar Diameter	16	20	25	28	32	40

COUPLERS

Cast Round Coupler

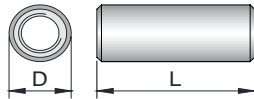

Article No. 526 01 ___ 3600	516	520	525	528	532	540
L mm	70	90	104	118	128	150
D mm	27	33	41	46	53	65
Unit Weight kg	0.17	0.32	0.57	0.82	1.20	2.09

We reserve the right to make changes and improvements to the products and/or the process which may result in benefit and/or changes to physical/mechanical characteristics.

The data contained herein are considered representative of current production and is believed to be reliable and to represent the best available characterization of the product as of April 2016.